

Source: **own catalogue - Own**
Component: **Typical Shepherd Spacemaker House**

OUTSIDE

INSIDE

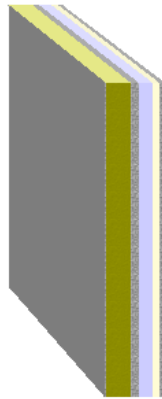

Assignment: External wall

	Manufacturer	Name	Thickness [m], number	Lambda [W/(mK)]	Q	R [m²K/W]
		R _{se}				0.04
<input checked="" type="checkbox"/>	1 WBS	WBS Silicone Render	0.008	0.556	E	0.01
<input checked="" type="checkbox"/>	2 WBS	WBS Mineral Fibre	0.090	0.037	E	2.43
		Fixings	8/m²	0.500	D	-
		Air gaps				
		Level 1: dU" = 0.01 W/(m²K)				
<input checked="" type="checkbox"/>	3 Own catalogue	Concrete, Medium density 1800	0.032	1.150	E	0.03
<input checked="" type="checkbox"/>	4 Own catalogue	Normal cavity - 50 mm, unventilated	0.050	0.278	E	0.18
<input checked="" type="checkbox"/>	5 Glass Fibre Insulation	Glass Fibre insulation	0.025	0.044	E	0.57
<input checked="" type="checkbox"/>	6 Own catalogue	Gypsum Plasterboard	0.013	0.250	E	0.05
		R _{si}				0.13
						0.218

$$R_T = R_{si} + \sum R_i + R_{se} = 3.44 \text{ m}^2\text{K/W}$$

Correction to U-value for	according to	delta U [W/(m²K)]
Mechanical fasteners	BS EN ISO 6946 Annex D	0.000
Air gaps	BS EN ISO 6946 Annex D	0.005
<i>Air gaps and fixings corrections need not be applied, as their total effect is less than 3% (Annex D BS 6946:1996).</i>		
		0.000

$$U = 1/R_T + \sum \Delta U = 0.29 \text{ W/(m}^2\text{K)}$$

- Q .. The physical values of the building materials has been graded by their level of quality. These 5 levels are the following
- A** .. A: Data is entered and validated by the manufacturer or supplier. Data is continuously tested by 3rd party.
 - B** .. B: Data is entered and validated by the manufacturer or supplier. Data is certified by 3rd party
 - C** .. C: Data is entered and validated by the manufacturer or supplier.
 - D** .. D: Information is entered by BuildDesk without special agreement with the manufacturer, supplier or others.
 - E** .. E: Information is entered by the user of the BuildDesk software without special agreement with the manufacturer, supplier or others.

$$U_{\max} = \boxed{0.35 \text{ W/(m}^2\text{K)}}$$

$$U = \boxed{0.29 \text{ W/(m}^2\text{K)}}$$

$$R_T = \boxed{3.44 \text{ m}^2\text{K/W}}$$

Source of U_{max} value: England, Wales: Approved Document L1A (2006), Table 2 - New Build Dwellings